



# Card Management Flow

Link Debit Card to Savings Account

# Link Debit Card to Savings Account



Step:

- 1 Login M2U Apps **Klik** ☰ **top left corner** > **Card Management**

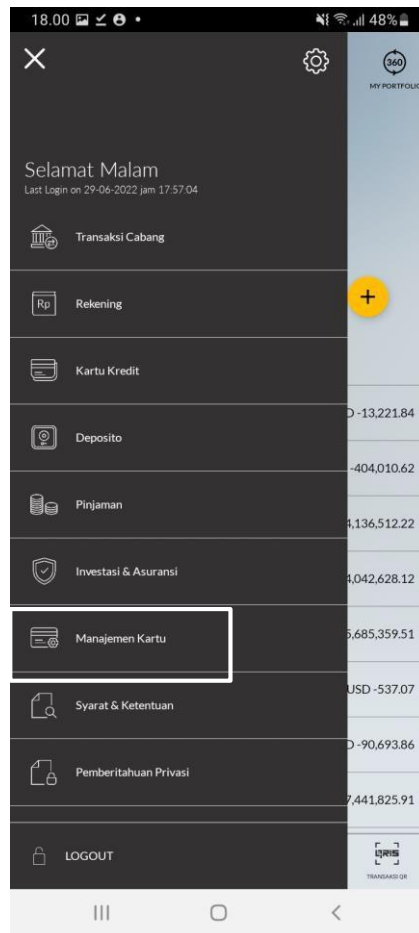

- 2 On screen Your Cards, **Select the Debit Card that you are going to link to Savings Account (Status : ACTIVE)** > **Click Link Card**

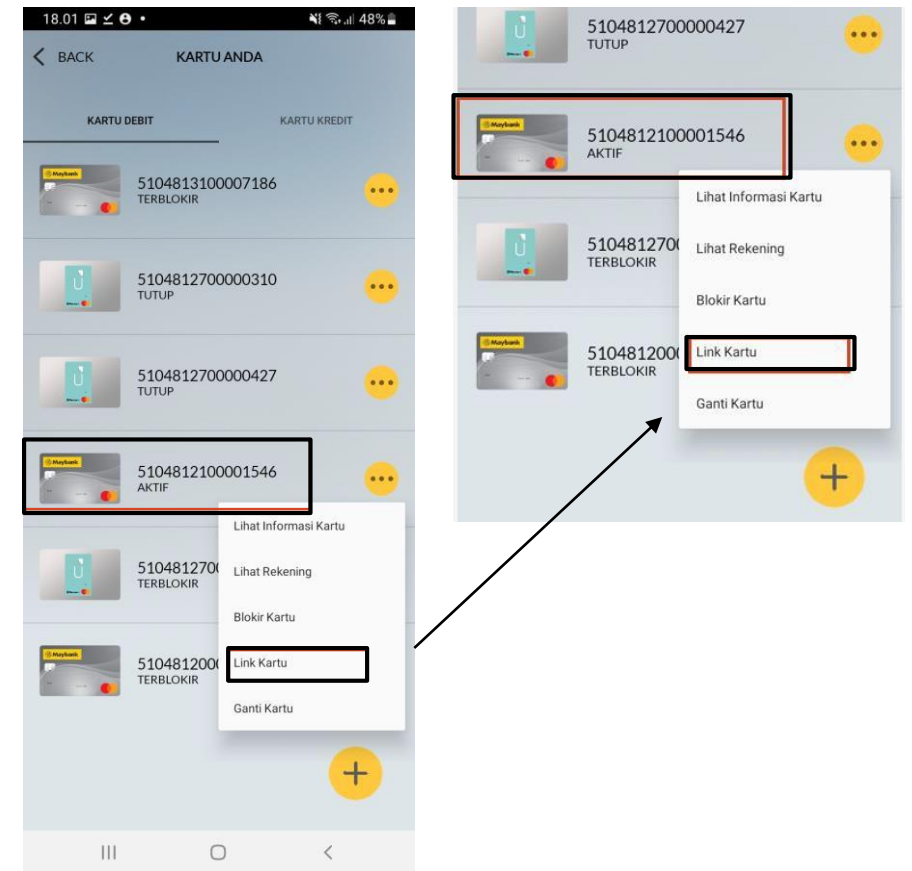



# Link Debit Card to Savings Account

Step:

3

On screen Savings Accounts **Choose the Account that will be linked** > On screen Detail Information, review whether the account is correct > **Confirm & Request TAC** > **Input SMS Token/ TAC** > **Link Debit Card is complete.**

